

# Testimony from an owner church...

On August 16, 2011, Bill Redmon met with me to explain the vision to build the James/John Cabin for the disabled on the Hillside area at Lake Aurora. Bill's vision and excitement for this project caught my attention immediately. As Bill spoke, he reminded me that just about everyone has an affiliation with someone who is handicapped/disabled. As I thought of that, I realized how true that statement was. I presented the idea of being a 'tithing church' to our Elders, with a goal to raise \$25,000 of the needed \$250,000 by the end of 2011. They accepted the challenge, and we invited Bill and Wendy to give a short presentation of the project at NBCC on Nov. 13, which kicked-off our seven (7) week drive to reach our goal.

The results have been amazing! People began to respond immediately, as I updated them each week through my message. I reminded the congregation of the opportunity to be a part of something that would allow the disabled to not just have a camp experience but even more, an opportunity to accept Jesus Christ as their Lord/Savior. NBCC looks forward to giving 'sweat equity' to this project.

As 2011 closed, we have been able to raise over \$28,000 thus far (we have changed our ultimate goal to \$30,000). By the way, there were no huge financial gifts...just a lot of people giving the very best they could for a cause they totally believed in!

We hope that YOU will consider coming on board and being a part of something that will have lasting repercussions for generations to come. Feel free to contact me for further information, or any questions.

In Christ, John A. Meisenbach (emize@juno.com)  
newbeginningscctampa.org

**Partners to date:**  
\$25,000 and up...  
New Beginnings Christian, Tampa  
Generations Christian, Trinity  
Labor/Skills: Real Life Christian, Clermont

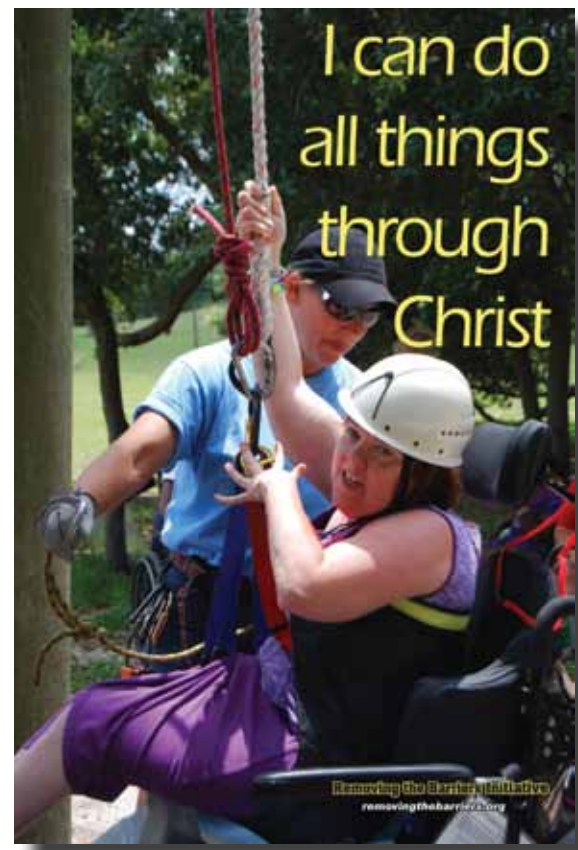

Lake Aurora now offers about 1,000 camper days of programming for people with disabilities and they are able to use Hillside Cabins because of the handicapped-accessible rest-rooms inside. This means a 1/4 mile trail for people in wheelchairs to traverse, or the blind to tap their way, just to have a chapel service in their meeting area off of the Dining Hall.

**A better solution is to build the two Hillside leadership cabins, James and John, as one large cabin.** By leaving out most of the interior walls, it can serve as a meeting room until a permanent auditorium is built. James and John would provide an assembly room nearly twice as large as the current space being used.

The additional assembly space would be a tremendous benefit during summer camp to allow the Hillside camp a dedicated meeting space outside of the dining hall as well as a great asset to the year round retreat season.

Nonprofit Org  
US Postage  
PAID  
Permit #569  
Ft Myers FL

Lake Aurora Christian Assembly, Inc.  
Summer Camp and Retreat Center  
237 Golden Bough Road  
Lake Wales, FL 33898-9410  
863.696.1102 www.lakeaurora.org



It's time to build...  
**James & John**  
a Cabin for ALL





# James and John Cabin ~ next build on the Hillside Campus

A desire to serve the  
least of these...

I want to help.

Two cabins, built as one, to provide a large meeting space by leaving out some interior walls, but will eventually be installed and serve its intended purposes.

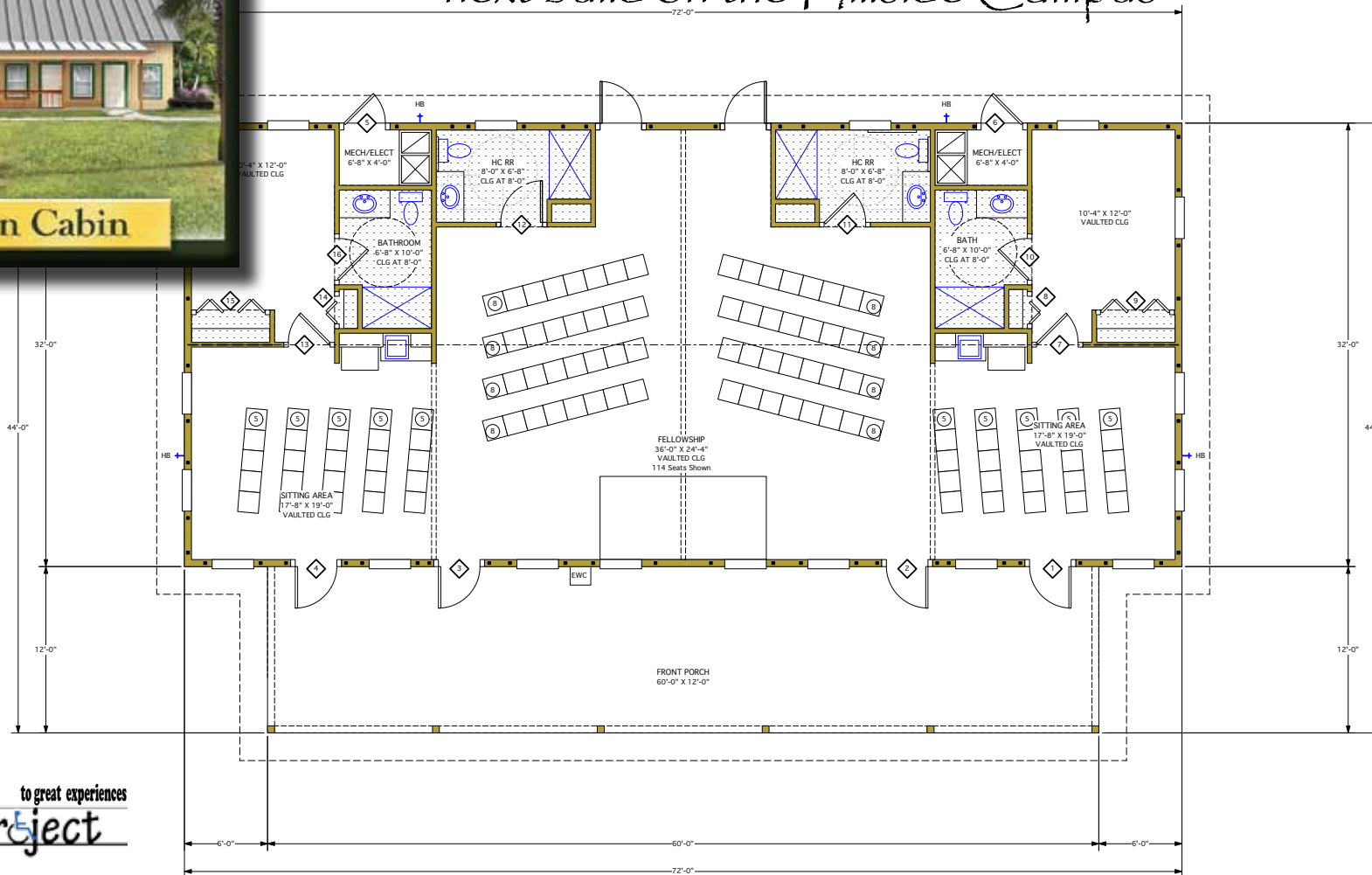

There are tens of thousands of us who have benefitted greatly from the ministry of Lake Aurora. Pulling together will help us get yesterday's work done. Surely we would all fit into one of the giving levels below:

- \$25,000...Have a name remembered by connecting it to one of the four sections of the cabin or to the porch.
- \$10,000...This is a great way for churches or blessed families to be a Gold Donor.
- \$5,000...Smaller churches or extended families could become Silver Donors.
- \$1,000...Write a message on a small piece of board and we will permanently attach it to a rafter when the building is built.
- \$500...Sign your name on one of the studs which will be used to build the walls.
- \$100...Like all major donors, receive the framable rendering of the James and John Cabin.

All gifts, of any size, large or small, demonstrate your willingness to make God's beautiful camp available to all people, regardless of their mental or physical abilities.



Name: \_\_\_\_\_

Address: \_\_\_\_\_

City: \_\_\_\_\_

ST: \_\_\_\_\_ Zip: \_\_\_\_\_

Phone: (\_\_\_\_) \_\_\_\_\_ Cell Home Work

Email: \_\_\_\_\_

Gift Enclosed \$ \_\_\_\_\_ (Cash/Check/Card)  
Charge to: Mastercard Am.Express Visa Discover

Card # \_\_\_\_\_  
Exp \_\_\_\_/\_\_\_\_

Print Holder's Name as it appears on card: \_\_\_\_\_

Holders' Signature: \_\_\_\_\_  
If cardholder address different from above, please include.

Set up an online donation at  
[www.lakeaurora.org/main/donate/donate.html](http://www.lakeaurora.org/main/donate/donate.html)



Or scan QR code at right

More ways to help

- Contact me - I want to learn more.
- I want to help with my skills and tools on this project.
- I have construction materials to donate.

LAKE AURORA CHRISTIAN CAMP  
237 Golden Bough Road Lake Wales, FL 33898  
863.696.1102 fax - 863.696.1062  
lakeaurora.org

